



## Instruction Manual

To ensure maximum performance and safety, please follow this manual. Please retain the manual for future reference after installation.

## Introduction

This instruction manual is for your safety and must be adhered to at all times. Please read, ensure that you fully understand the installation and set up procedures as explained and if you are unclear on the installation or set up of your VIBE SE-K Series components please contact your nearest authorised VIBE dealer.

## Contents

2 x SE-K series speakers.  
2 x Tweeters and mounting pods.  
2 x SE-K crossover units.  
2 x Grills.  
8 x Fixing screws.  
1 x Cut out template.  
2 Lengths of speaker cable.

## Standard Features

25mm PEI dome Neodymium tweeter in flush mount / surface mount pod.  
Pivoting tweeters for directional sound.  
Kevlar Woofer for increased cone stiffness sensitivity.  
VIBE crossover units with integral glow fuse and 12 dB attenuator.

## WARNING

DO NOT EXPOSE THIS PRODUCT TO DAMP OR MOISTURE - doing so may result in fire, shock or damage to the product.  
BEFORE WIRING DISCONNECT THE CABLE FROM THE POSITIVE BATTERY TERMINAL - failure to do so may result in electric shock or injury.  
ENSURE GOOD AND CORRECT CONNECTIONS - failure to make the correct connections may result in fire or damage to the product.  
DO NOT USE FUNCTIONS OF THIS EQUIPMENT THAT MAY TAKE YOUR CONCENTRATION AWAY FROM DRIVING YOUR VEHICLE - do not set up your amplifier whilst driving, doing so may result in an accident.  
For prolonged setting up, make sure that your vehicle is stationary and in a safe location.  
KEEP THE VOLUME AT A LEVEL SO YOU CAN STILL HEAR OUTSIDE NOISE - failure to do this may result in an accident. VIBE equipment is capable of producing sound levels that can permanently damage your hearing. VIBE recommends caution when listening at high volume. For safe and enjoyable listening the sound should be comfortable and clear without distortion.

## CAUTION

Never connect any speaker lead to the car chassis. This can cause severe damage to your speaker /car radio /amplifier.  
Before drilling or cutting any holes, investigate the layout of your vehicle thoroughly.  
Use caution when working near the fuel / hydraulic lines and electrical wiring.  
Observe the correct polarity when wiring, improper phasing may cause a loss of bass response.  
Ensure that no moving parts catch on the speaker or grill (e.g. window or door handles, or window glass inside the door)

## Installation

The quality of the installation will affect the system performance and reliability.  
Contact your nearest authorised VIBE dealer if you are unsure on the installation of this product.  
Please mount this unit away from any potential hazards.  
Minimising the length of wires will provide higher audio output from the system.  
The speaker should be securely fastened to the mounting position using the screws provided.  
Pre drill your mounting holes using a drill and position with the template provided.  
Be sure to investigate your mounting area thoroughly for electrical wires, brake or fuel lines or fuel tank to prevent causing any damage.

Firstly make sure that the speakers will fit in your chosen location. This may involve the removal of the standard vehicle speakers. Please use the mounting depth and hole cut dimensions as detailed in this manual for guidance.

## Woofer installation.

If necessary cut any material away to allow the speaker to sit correctly.

Cut out the mounting hole and pre-drill any other fixing holes.

If the grill is to be fitted, place it over the speaker and screw through both grill and speaker using the screw provided until the speaker is securely fastened.

If no grill is fitted then securely screw the speaker into place using the screws provided.

### Surface mount tweeter installation.

Locate a suitable position for the tweeter. Many positions will provide good sound quality. For optimum staging, position tweeter higher than woofer but within 5" to 10" of the woofer.

Carefully unscrew the tweeter casing and remove the tweeter.

Using the base of the casing mark the two mounting holes and a hole for passing the wire through.

Cut out these holes.

Pass the tweeter cable through the bottom of the case and into the previously drilled holes.

Securely fix the base of the tweeter in place using the screws provided.

Select whether the standard casing or the slightly angled casing is to be used and carefully screw the tweeter casing back together, ensuring that no cable gets trapped.

The tweeter direction should then be adjusted so that the tweeter is focused towards the listener.

### Flush mount tweeter installation

Locate a suitable position for the tweeter. Many positions will provide good sound quality. For optimum staging, position tweeter higher than woofer but within 5 to 10" of the woofer.

Use the cut out template and mark and cut out the hole for the tweeter to sit into.

Place the entire tweeter pod into the hole.

From the rear of the tweeter. Slide the grooved locking device over the tweeter cable and then over the back of the tweeter case to firmly hold it in place.

The Tweeter direction should then be adjusted so that the tweeter is focused towards the listener.

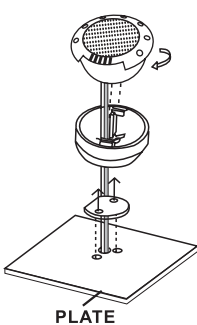

Figure 1

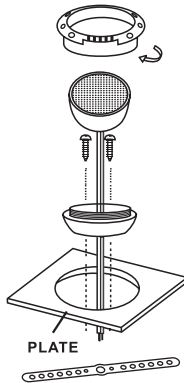

Figure 2

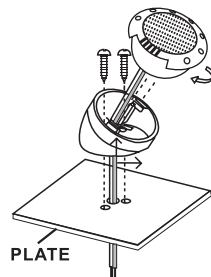

Figure 3

### Crossover installation

The crossover units are designed to be mounted as close to the woofers as possible.

Locate a suitable mounting place for them.

Remove the lid by using the finger hole in the top of the cover.

Mark the two mounting holes inside the crossover unit.

Cut these holes out.

Secure the crossovers with the screw provided.

Check the glow fuse is not damaged before refitting the cover. If it is please ensure it is replaced with one of exactly the same specification.

Wiring

Follow this diagram to wire your SE-K speakers.

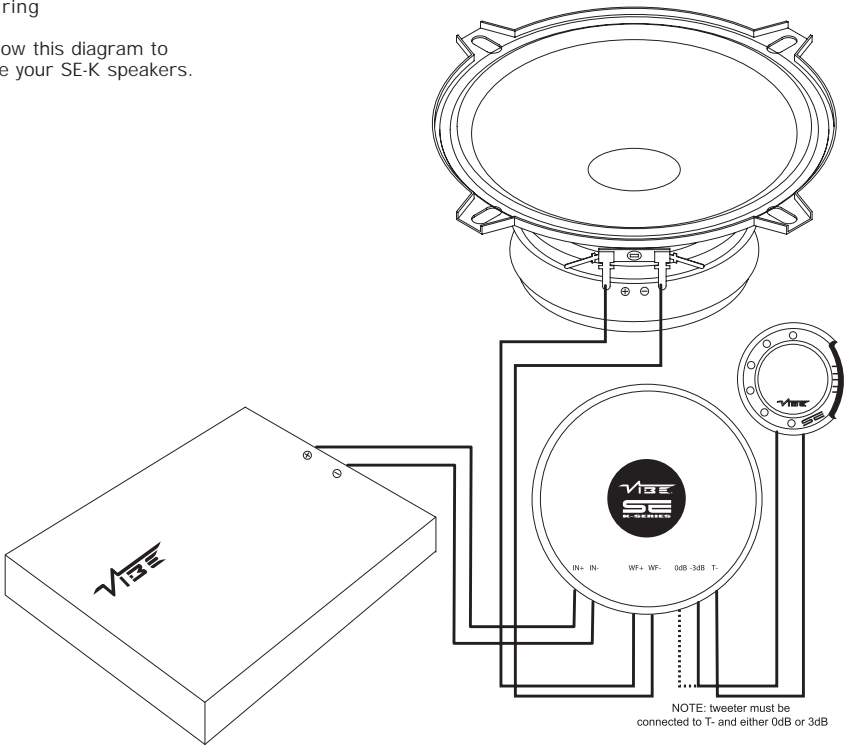

Parameters for SEK 5"	Parameters for SEK 6"
Revc = 3.4 Ohm	Revc = 3.4 Ohm
Fo = 92.118 Hz	Fo = 77.441 Hz
Sd = 8.659 M	Sd = 13.070 M
Md = 7.910 g	Md = 10.700 g
BL = 3.882 T	BL = 4.707 T
Qms = 10.603	Qms = 11.048 8
Qes = 0.901	Qes = 0.797
Qts = 0.831	Qts = 0.744
No = 0.386 %	No = 0.541 %
SPLo = 87.9 dB	SPLo = 89.3 dB
Vas = 4.605 m	Vas = 9.596 m
Cms = 432.522 u M/N	Cms = 395.614 u M/N
Krm = 70.636u Ohm	Krm = 1.62864 Ohm
Erm = 1.048	Erm = 0.983
Mms = 6.901 g	Mms = 10.677 g
Mmd = 6.438 Kg	Mmd = 9.817 Kg
Kxm = 2.386 m H	Kxm = 4.607 m H
Exm = 0.758	Exm = 0.7

Mounting depth:	SEK50: 60MM+0.5MM
	SEK60: 65MM+0.5MM
Mounting dimension:	SEK50: 121MM+0.5MM
	SEK60: 144MM+0.5MM

Copyright

All content included in this manual such as text, graphics, logos, icons, images, data, is the property of VIBE Technologies Ltd. and is protected by United Kingdom and International copyright laws.

DISCLAIMER

VIBE DOES NOT REPRESENT OR WARRANT THAT THE INFORMATION CONTAINED IN THIS MANUAL IS COMPLETE OR CURRENT, AND THAT ALL SPECIFICATIONS AND INFORMATION CONTAINED WITHIN THIS MANUAL ARE SUBJECT TO CHANGE WITHOUT NOTICE. VIBE RECOMMEND CAUTION WHEN LISTENING TO MUSIC REPRODUCED THROUGH VIBE EQUIPMENT. VIBE EQUIPMENT IS CAPABLE OF PRODUCING SOUND AND SOUND PRESSURE LEVELS THAT CAN PERMANENTLY DAMAGE HEARING OF YOU AND THAT OF OTHERS. FOR SAFE AND ENJOYABLE LISTENING, THE SOUND SHOULD BE CLEAR WITHOUT DISTORTION AT A COMFORTABLE VOLUME. BY USING ANY VIBE EQUIPMENT, YOU AGREE TO TAKE FULL RESPONSIBILITY FOR YOUR OWN SAFETY AND THE SAFETY OF OTHERS WHEN LISTENING TO MUSIC AT HIGH VOLUMES THROUGH EQUIPMENT YOU HAVE PURCHASED. USE OF ANY VIBE EQUIPMENT CONSTITUTES AGREEMENT TO THIS DISCLAIMER.